

TPMS INSTALLATION GUIDE:

Internal Sensors (Magnetic Mount)

1 START

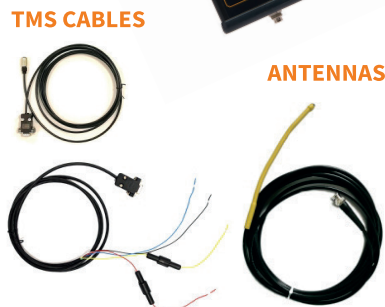

You will need:

- Laptop. In a web browser visit app.tiremonitorsystem.com. If you have visited it once, the TMS App will work even while you are not connected to the internet
- Bailer/towel to remove water
- Chalk
- Buffing contour wheel
- Buffing dust remover eg vacuum
- Blue cement (see section 3C)
- Stitcher
- Tire sealant
- Tools and fixing to mount the Hub
- Crimp tool: insulated terminals/splices
- Selection of cable ties, crimps and terminals

Write down the sensor ID code for the corresponding wheel. This will be helpful when you get to section 6.

Wheel #	ID Code
1	
2	
2	
4	
5	
6	

3 SENSOR INSTALLATION

If magnetic mounts are used, these can be mounted to the rim in a number of different ways. This will depend on the type of rim construction and the site's procedures relating to rim assembly and tire fitting.

In some cases, it will be necessary to use a tool to fit the Sensor part way through the fitting of a tire when one bead is fitted over the rim. This tool is used to ensure that the sensor can be fitted without getting the operator's hands or arms in harm's way.

Please ensure you review your own fitting procedures to ensure they comply with all your company's health and safety policies and no operators are put at risk.

A Fit the two Magnetic Mounts into the end of the Sensor and ensure they are pushed completely into the circular hole. The Magnetic Mounts are fitted by stretching each toggle in turn and pushing the opening at the end of the Sensor over the neck of the toggle.

B Ensure that the shoulders of each toggle are seated correctly into the recesses on the Sensor.



The left Sensor is fitted correctly. The right Sensor is not fitted correctly.

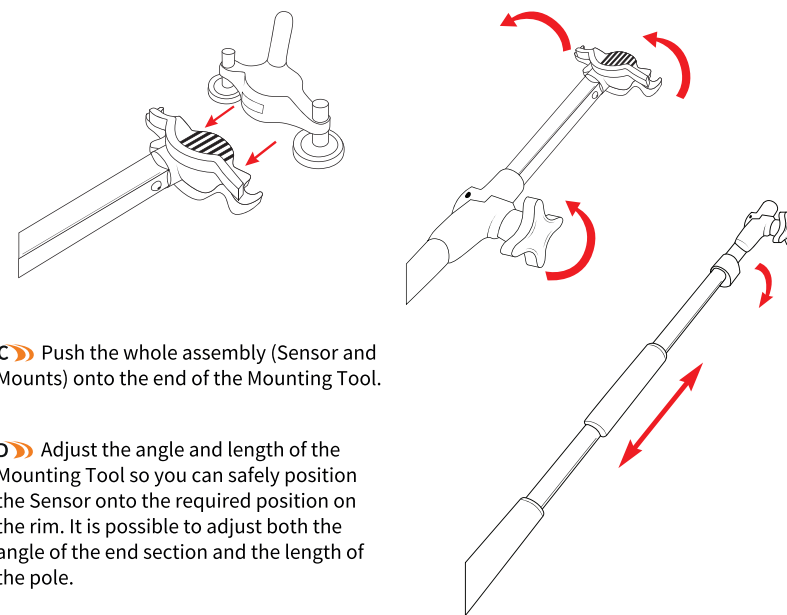

C Push the whole assembly (Sensor and Mounts) onto the end of the Mounting Tool.

D Adjust the angle and length of the Mounting Tool so you can safely position the Sensor onto the required position on the rim. It is possible to adjust both the angle of the end section and the length of the pole.

E Use the Mounting Tool to position the Sensor as required on the rim. Because the magnets used are extremely powerful it will be difficult to move the Sensor when attached to the rim. So ensure that you stay a sufficient distance from the rim until it is in the required position.

F When the Sensor is firmly attached to the rim. Simply pull back the Mounting Tool - this will detach from the Sensor and allow the Tool to be withdrawn from the tire, leaving the Sensor in position.

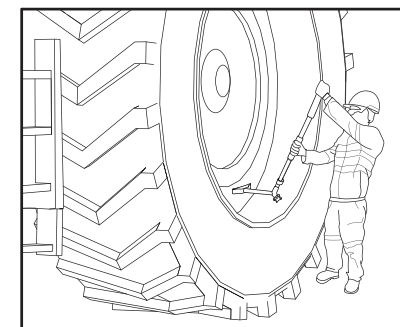

2 HUB & DISPLAY INSTALLATION



The Hub is the central part of your kit. It's where the power is distributed and where all the antennas connect. Some key points to follow:

- Install the Hub where it can be connected to the vehicle supply.
- Install the Hub within reach of the Display using the TMS Cable.
- Install the Hub where it is feasible to connect the antennas.



The Display should be positioned so that the operator can easily see the display. It is recommended that you attach the Display to your dashboard. Some key points to follow:

- Install the Display within reach of the Hub.
- A velcro pad has been provided to help you attach your Display to the interior of your vehicle.

4 ANTENNA INSTALLATION

Up to 100 tonnes

Use the 8 metre antenna cable provided for the side furthest from the Hub

Use the 5 metre antenna cable provided for the side closest to the Hub

Caution ESD. Do not install or work on antennas while they are connected to your Hub.

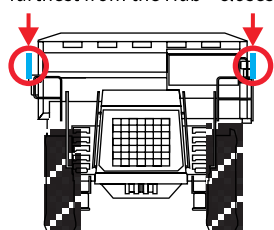

Antenna active end

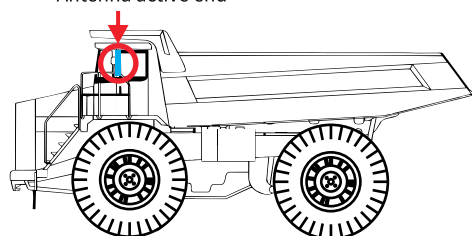

A Route the antennas from the Hub to the wing mirrors and secure them.

B When you are satisfied that they are secure, plug the antennas into the Hub unit using antenna ports 1 & 2.

100 tonnes and over

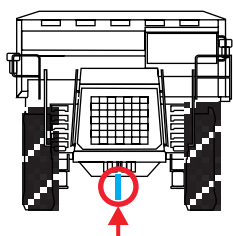

Antenna active end

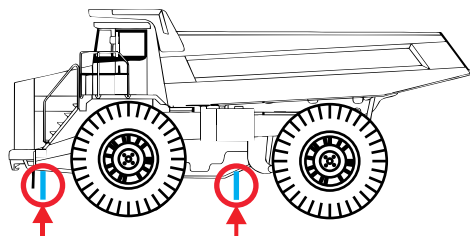

Use the 8 metre antenna cable provided for the side closest to the Hub

Use the 16 metre antenna cable provided for the side furthest from the Hub

A Route the antennas from the Hub to the underneath and secure them.

B When you are satisfied that they are secure, plug the antennas into the Hub unit using antenna ports 1 & 2.

6 CONFIGURATION

A In a web browser open app.tiremonitorsystem.com. Plug the USB lead from the Hub into your PC/Tablet or Smartphone. Connect the Hub.

C Enter the TMS Sensor ID of each wheel. You can use the App or you can use the Display. To use the Display press and hold a wheel until you see the setting screen.

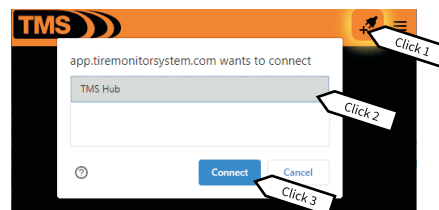

B Set up the wheel layout

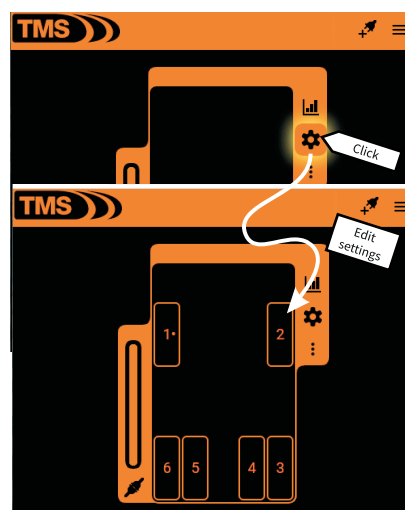

5 SYSTEM CONNECTIONS

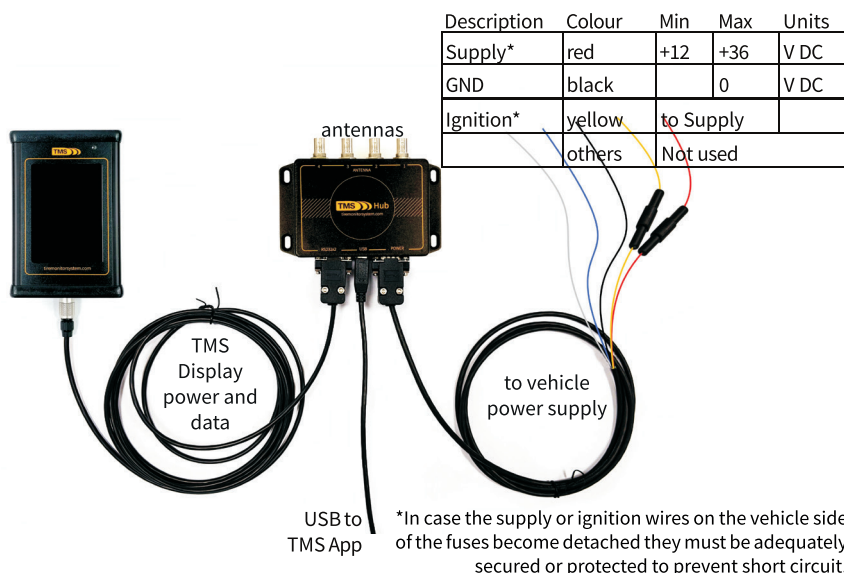

CONTACT DETAILS

Tire Monitor System Limited
West Road House, West Road, Buxton, SK17 6HF, UK
www.tiremonitorsystem.com

Hereby, Tire Monitor System Ltd declares that the radio equipment type TMS2A, TMS23A, TMS24A, TMS35 and TMS28 is in compliance with Directive 2014/53/EU and that TMS34 is in compliance with Directive 2014/30/EU. The full text of the EU declaration of conformity is available at www.tiremonitorsystem.com/downloads.

RF: 433 MHz 1 mW Max

Made in the UK

